

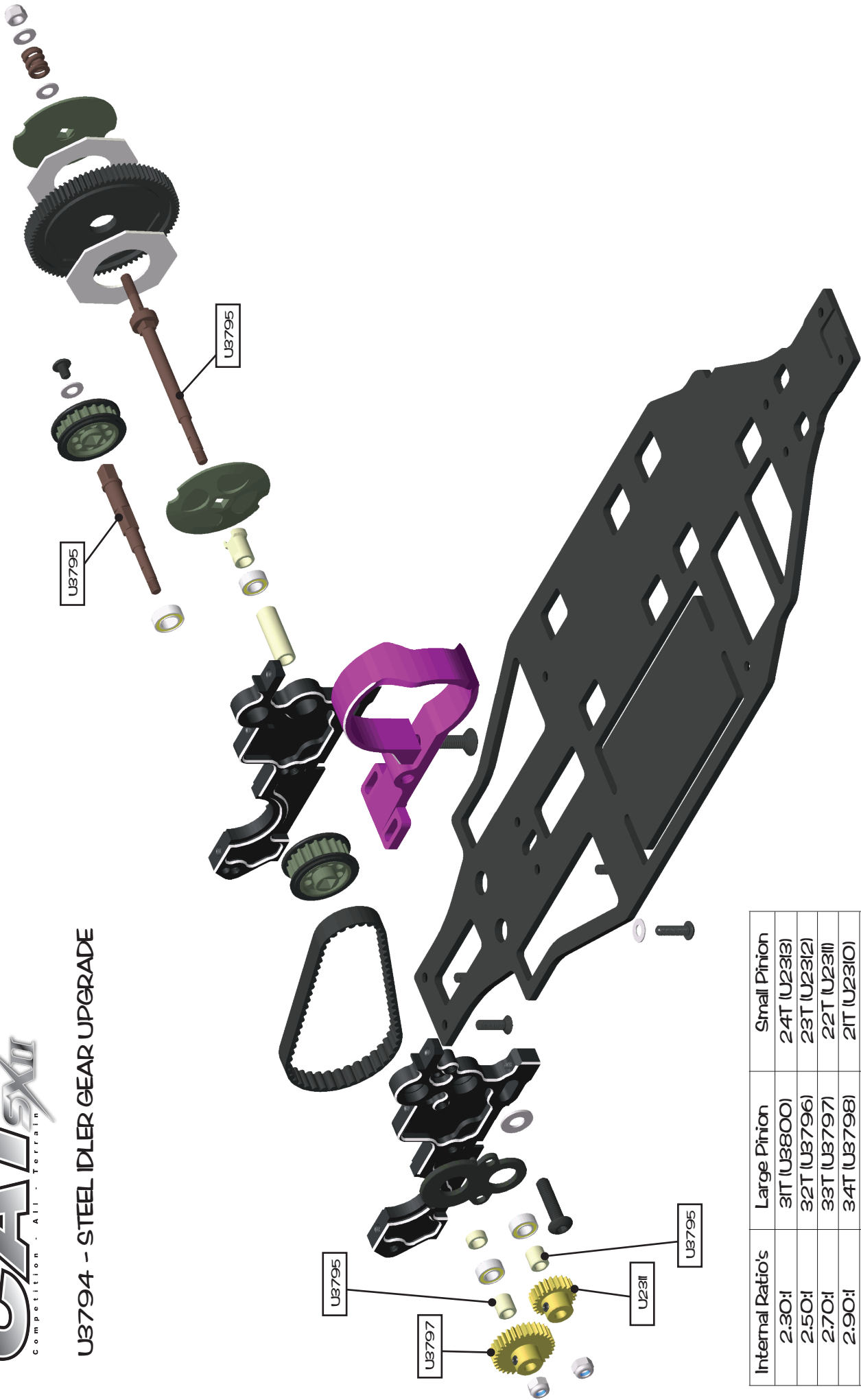

U3794 - STEEL IDLER GEAR UPGRADE



Internal Ratio's	Large Pinion	Small Pinion
2.30:1	31T (U3800)	24T (U2313)
2.50:1	32T (U3796)	23T (U2312)
2.70:1	33T (U3797)	22T (U2311)
2.90:1	34T (U3798)	21T (U2310)
3.15:1	35T (U3801)	20T (U2309)

Step 2 A

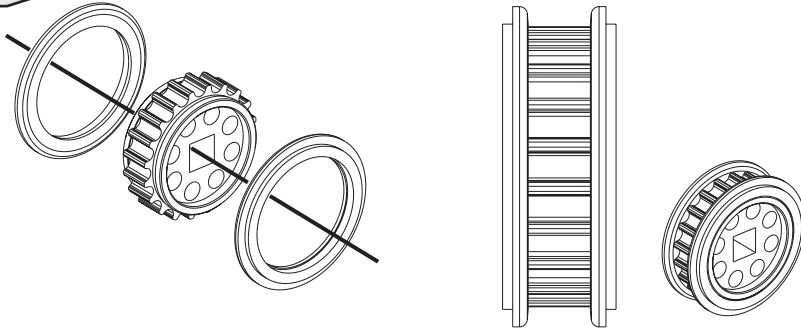

Step 2 B

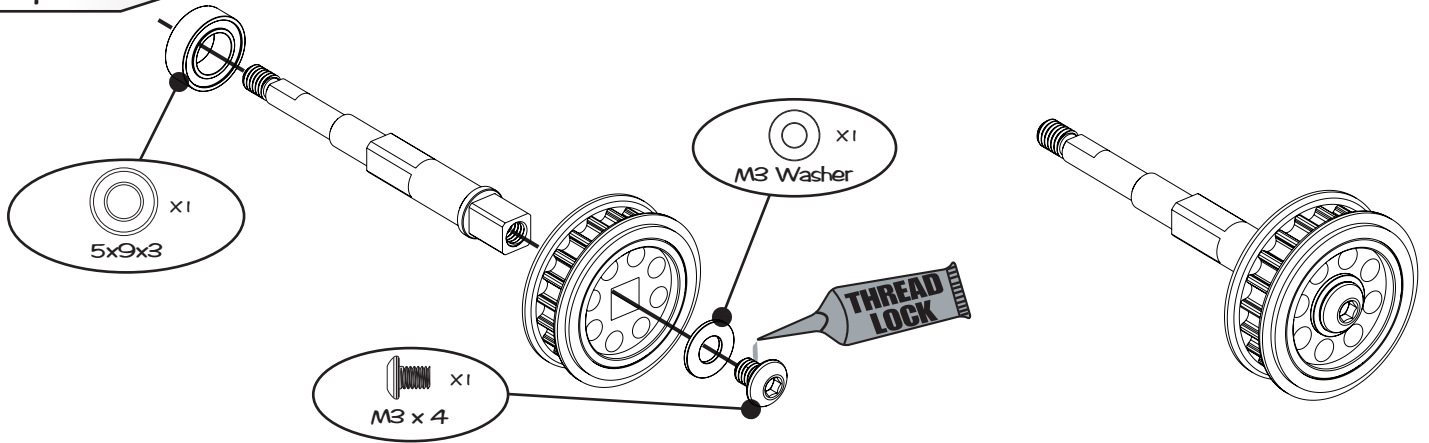

Step 2 C

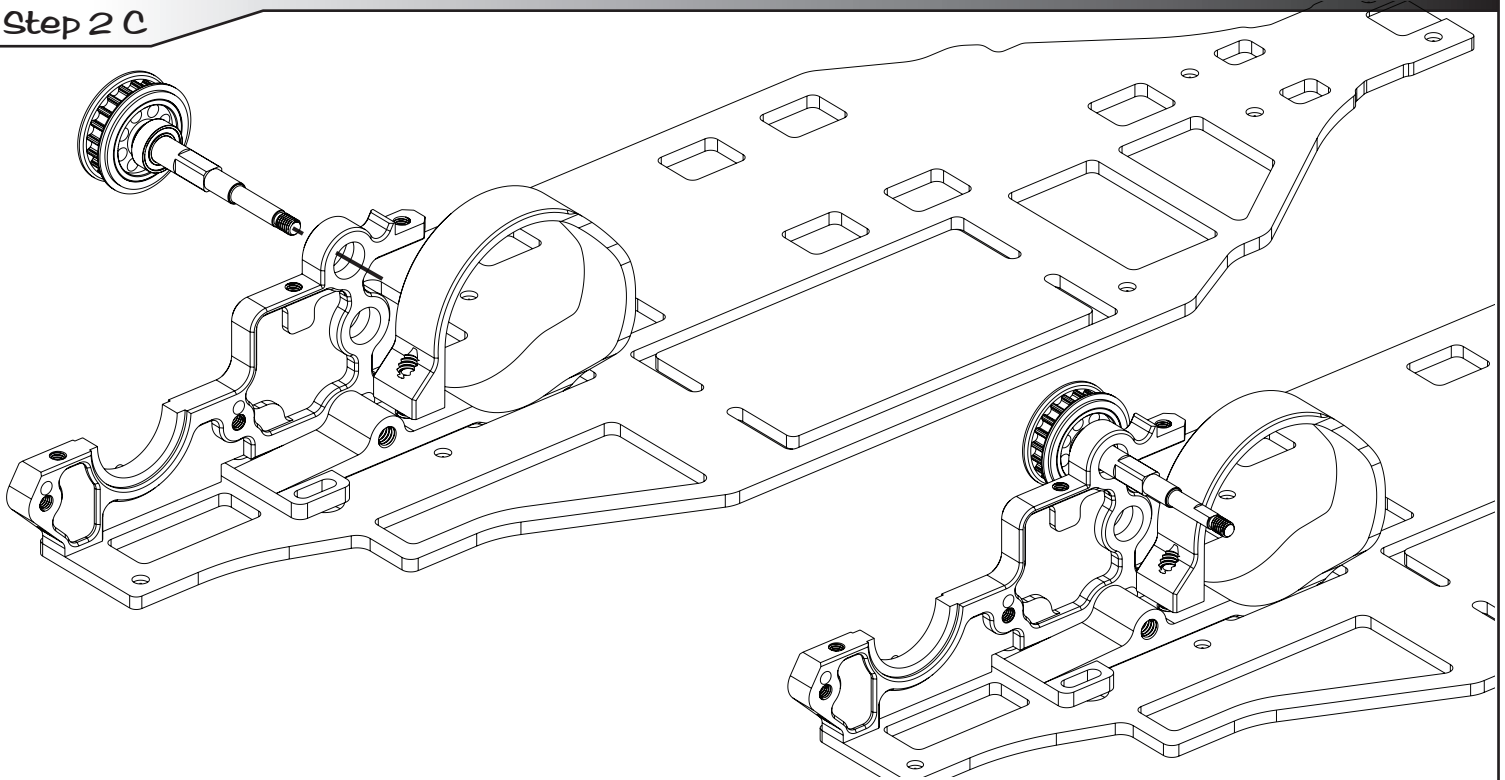

Step 3 A

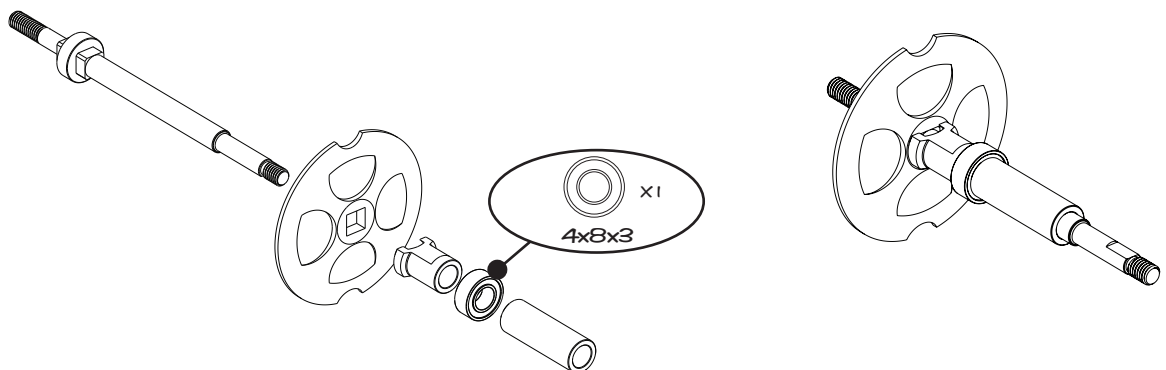

Step 5 B

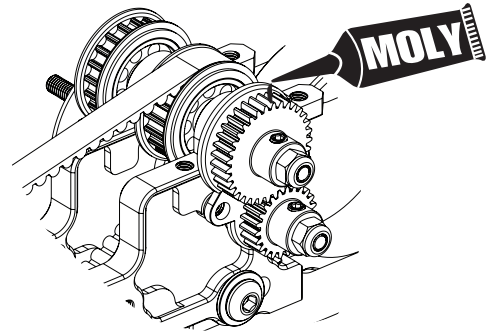
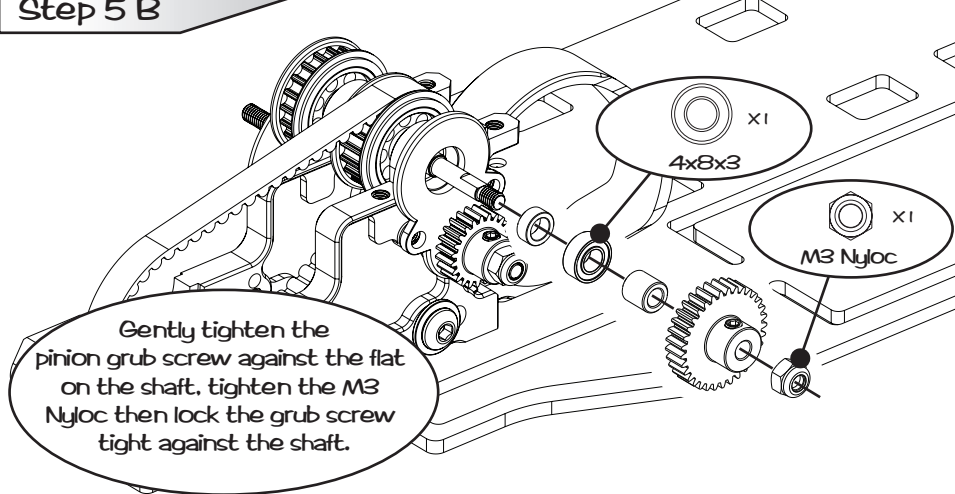

Step 6

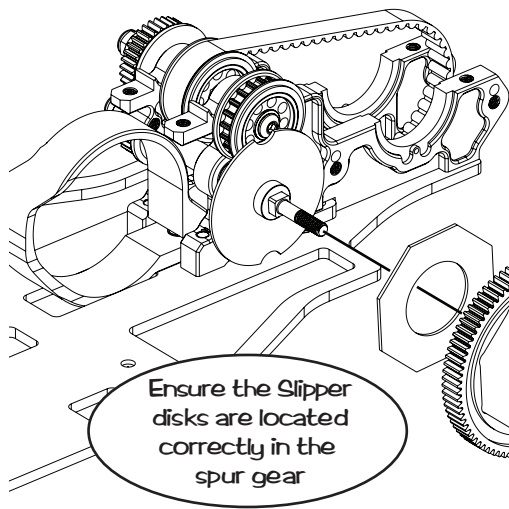

NEVER run with the slipper loose. The Slipper is used to reduce wheelspin. It should not slip for more than 1 Second during acceleration on full power. Excessive slip will melt the spur gear.

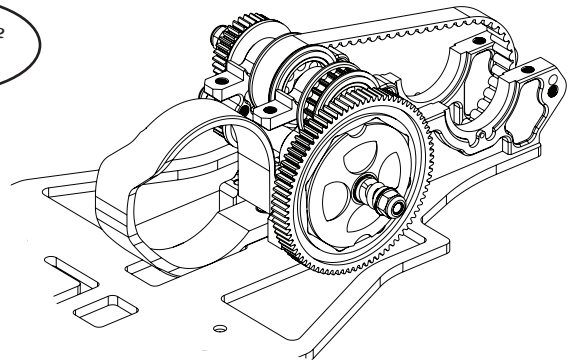
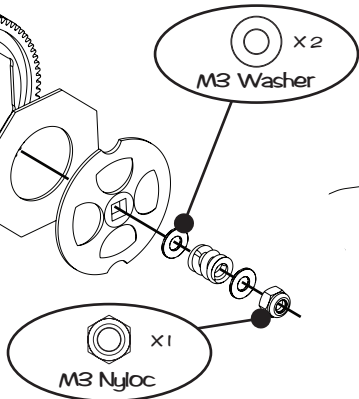

Step 7 A

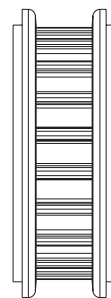
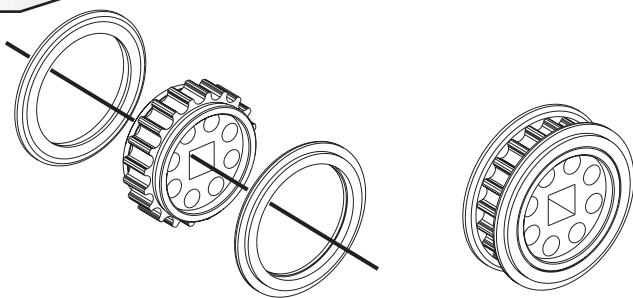

Step 7 B

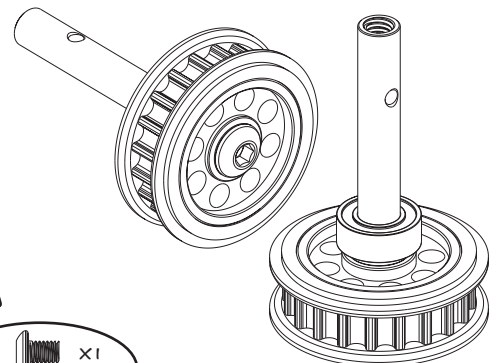
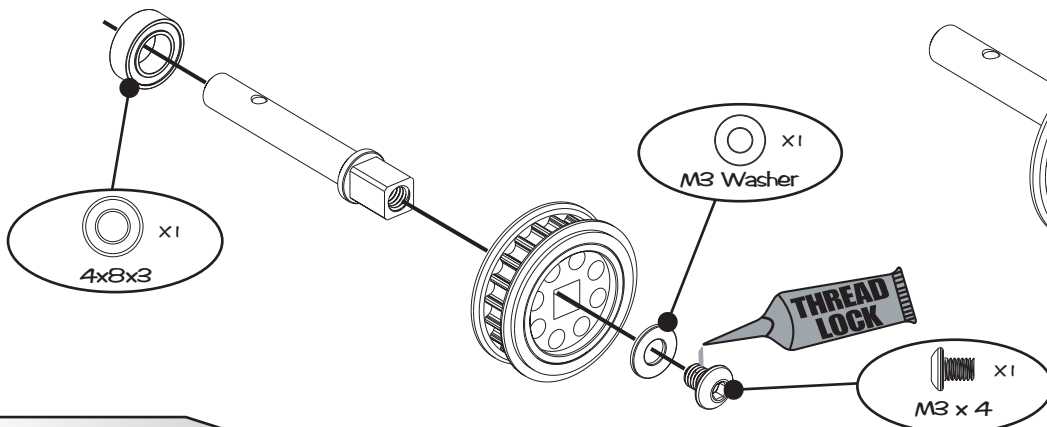

Step 3 B

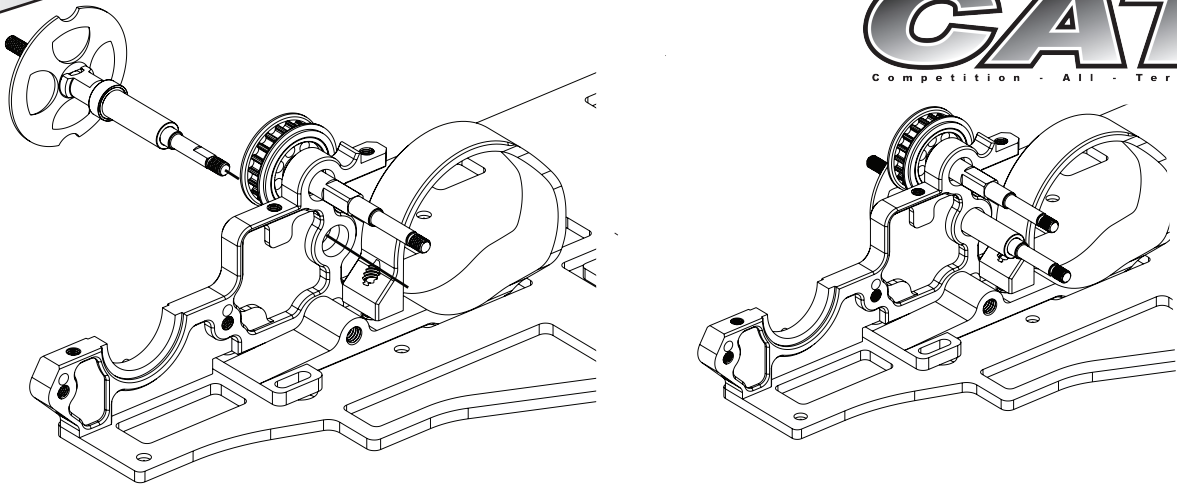

Step 4 A

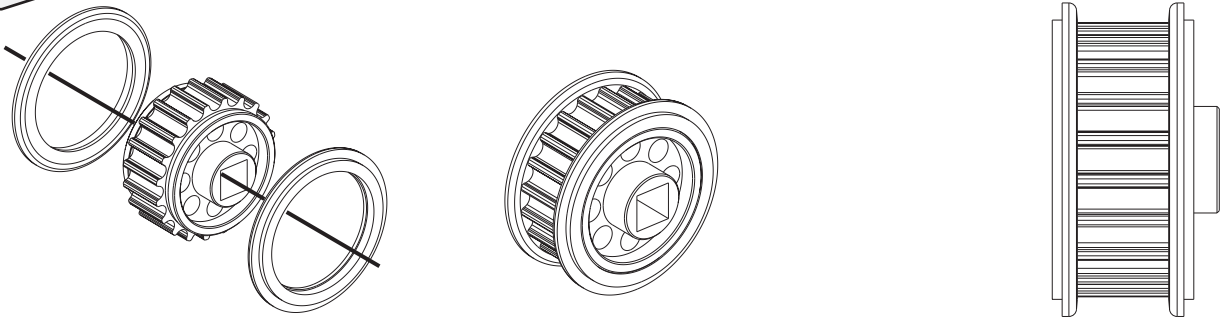

Step 4 B

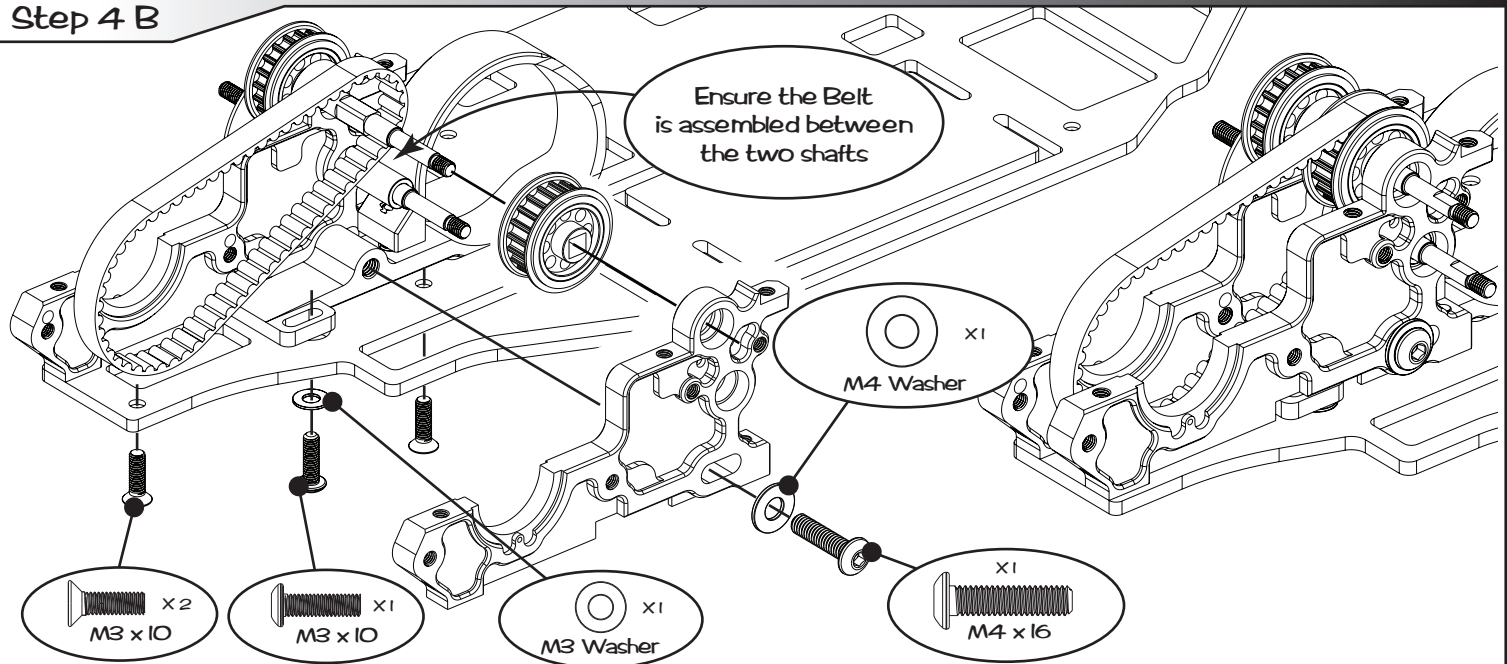

Step 5 A

